



**Nederman**

# NFPZ

Baghouse dust collector with container





# Simple, Quiet and Safe Wood Dust Extraction Systems

## Simple and effective wood dust extraction solutions

Nederman's NFPZ is a convenient and high-performing wood dust collection solution for small to mid-size woodworking manufacturing or education sites. Featuring the SUPERBAG filters, the NFPZ offers high filtration efficiency, extended filter life energy efficiency reducing emissions and operational cost.

The design complies with the latest NFPA and ATEX combustible dust requirements and can be configured to a facility's unique needs to ensure safe operation and compliance with local standards and regulations.

The NFPZ is a flexible design that includes design features that ensures easy operation and maintenance of the solution.

- Modular and configurable design
- Automatic shaker filter cleaning
- Quiet operation (ideal for schools)
- Integral fan mounting saving footprint
- Bags, barrels or bin waste collection options
- Suitable for outdoor installation



## Common Applications

- Woodworking trade schools
- High-Speed Routing
- Sawing & Cutting
- Single-Cell Manufacturing
- Intermittent or light wood processing

## The global leader in clean air solutions for the woodworking industry

As the world's largest provider of industrial air pollution control equipment, Nederman is your total solution provider for controlling woodworking dust. Whether the application is small or large, simple or complex, manual or automated, Nederman assesses each customers' unique needs and develops solutions that effectively and efficiently protect your workers and factory.

- **Industry Expertise.** Right solutions that ensure safety and efficient operation. With tens of thousands of successful installations, you can trust Nederman to get the job done.
- **Comprehensive Approach.** We manufacture the fans, duct, controls, safety devices and offer project installation, commission and service support.
- **Solution Range.** A robust line-up products and services that meet the unique needs of the woodworking industry.

### Combustible dust experts

Nederman is the global leader for ATEX and NFPA compliant dust collection solutions. Our comprehensive approach throughout the design, installation and maintenance processes sets us apart.

This approach begins with our sales and technical support teams who go through regular, rigorous training and follow a strict process to ensure the latest standards are being followed for each project. Next, we manufacture and select each component of the dust collection system including safety devices, so you can be confident you have a complete and compliant solution. Finally, Nederman offers both on-site and digital monitoring services to assist customers in the operation and maintenance of the system in a safe and compliant manner.



- **Quality and Reliability.** Problems that result in lost production impact the bottom line. Nederman solutions are engineered with this in mind to keep you operational.
- **Global Presence.** Regional sales offices and network of distribution partners uniquely positions Nederman to support your local factory or global operations
- **Sustainability.** Energy efficient operation, extended filter life and effective recovery of waste material to be reused or recycled.

### Did you know?

According to Dust Safety Science, approximately 25% of fires and explosions occurred within wood industries with dust collectors being the highest source of incidents and injuries.





# Effective operation, innovative filter technology and comprehensive range



## How it Works

During normal operation:

- 1 Dust laden air from the plant travels down the supply duct
- 2 Dust then enters the hopper section of the filter
- 3 As air slows down within the hopper, the heavier dust particles fall down into the inside of the collection bags
- 4 The remaining dust then travels up into the inside of the filter bag
- 5 The air, which originated from the plant, is now clean and passes through the filter bag into the surrounding atmosphere. May exhaust to outside or be ducted back to building via proper designed return air system

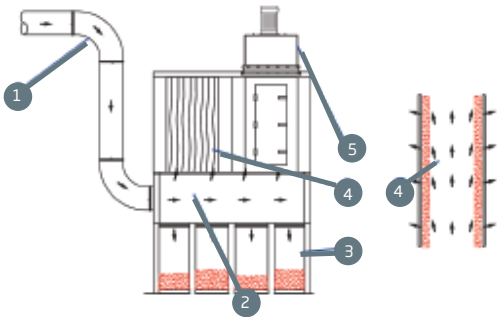

While cleaning:

- 1 The NFPZ may only clean "off-line", when the COMBIFAB fan has stopped rotating
- 2 A shaker mechanism is automatically started when the fan is stopped and operates for a set period
- 3 The dust, which remains on the inside of the filter bag after the 'shake' is loosened from the filter fabric
- 4 The dust which is removed during the cleaning cycle falls into the collection bags/barrels

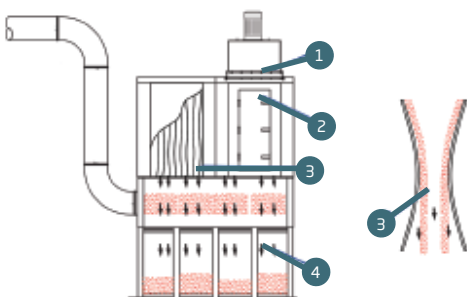

## Technical Specifications

NFPZ Model	Filter Quantity	Filter Area		Maximum Airflow		FM Fan Specifications			
		ft²	m²	ft³/min	m³/hr	Model	Power HP	Static Pressure in w.c.	Pa
NFPZ-1LE	25	215	20	1900	1,118	620	5	14	3,484
						625	7.5	17	4,230
NFPZ-2LE	50	430	40	3800	2,237	825	10	12	2,986
						828	15	17	4,230
NFPZ-3LE	75	645	60	5700	3,355	828	15	15	3,733
						831	20	17	4,230
NFPZ-4LE	100	860	80	7600	4,473	831	20	15	3,733
						860	25	17	4,230
NFPZ-2HE	50	900	84	7000	4,120	831	20	15	3,733
						860	25	17	4,230
NFPZ-3HE	75	1350	125	10500	6,180	(2) 828	15	16	3,981
						(2) 831	20	17	4,230

## Fan Performance Curves and Dimensions

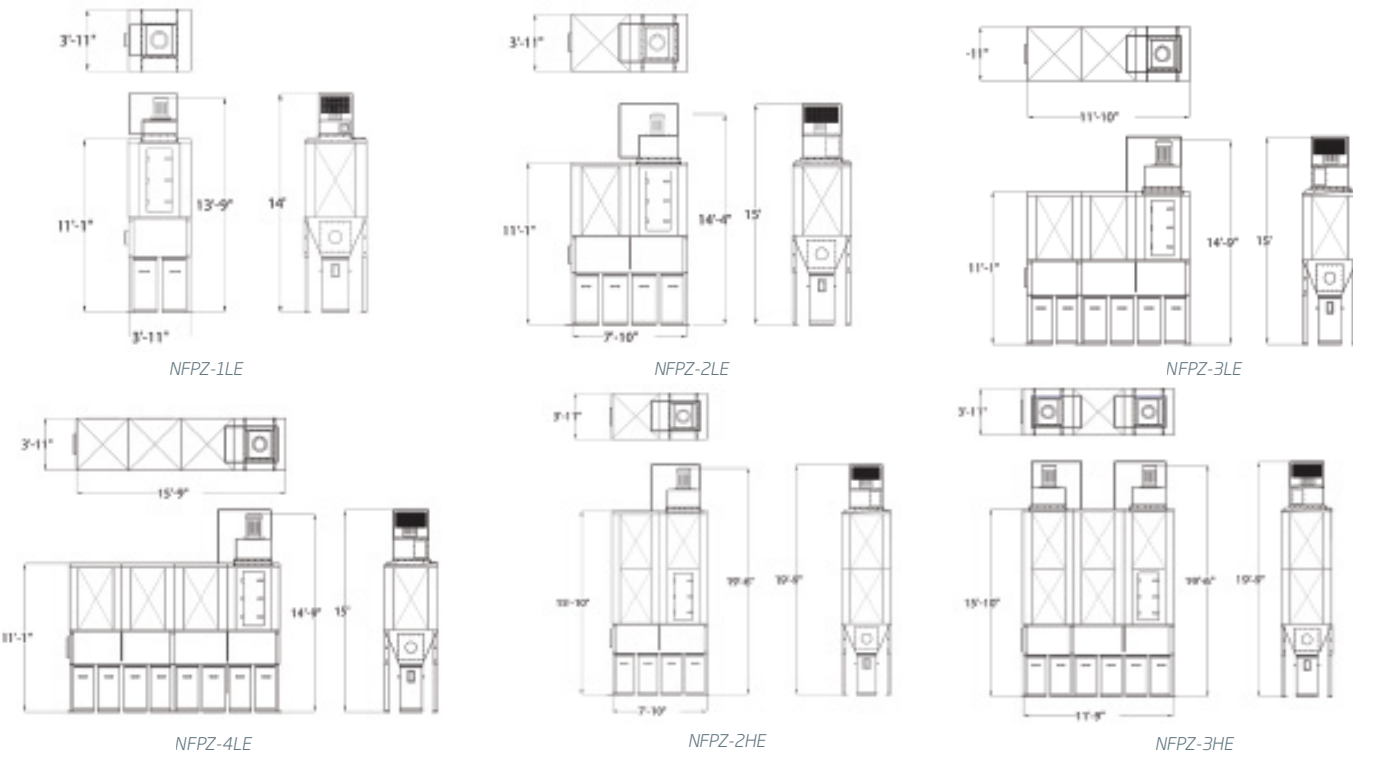
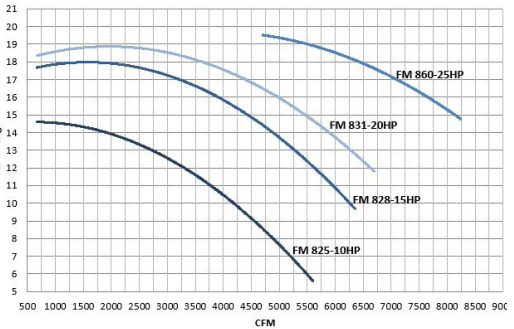
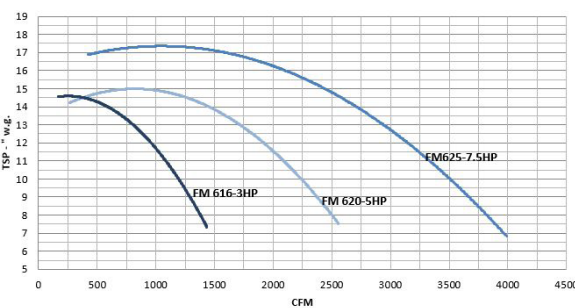

## SUPERBAG filters - the heart of the system

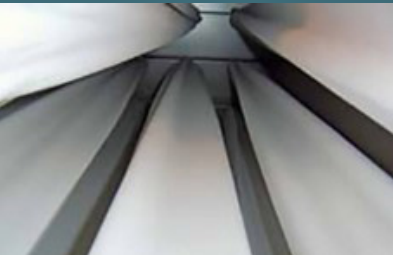

The Nederman SUPERBAG patented technology delivers high efficiency, low energy consumption, combustible dust safety and extended life.

- Emissions levels less than 0.1 mg/m³
- Low pressure drop requires less energy
- Durable construction with seamless, woven construction
- Reduced risk of fire and explosion with anti-static woven carbon fibers



# Complete Turn-Key Systems

Nederman has a full range of accessories and services that provide solutions based on customer unique needs. From the initial design, commissioning and installation to the service and maintenance to keep systems running efficiently.

## Accessories

### Exhaust Fans and Silencers

Nederman's family of FM and CombiFab Fans are a comprehensive family of blowers covering a wide range of performance requirements to optimize system performance. Box silencers are available to help keep noise levels as low as possible during operation.

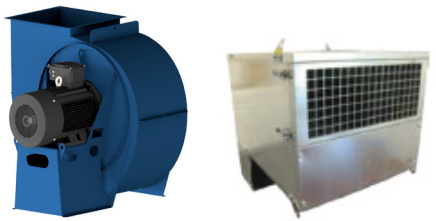

### Automation Control Panels

Our automation offering including fan starters & variable frequency drives (VFDs), automatic filter cleaning controls and a range of monitoring sensors to alert when maintenance or service is required.

### Combustible Dust Accessories

Isolation devices that prevent explosions originating in the dust collection system from propagating into the factory through the dirty or clean air duct. Nederman offers mechanical, abort gates, chemical and flameless isolation devices.



### Spark Detection and Fire Suppression

Detecting sparks on the inlet duct and extinguishing them before they enter the collector helps reduce risk of fire or explosion. To protect the collector in case of fire Nederman offers sprinkler couplings and dry suppressant systems.

### Nordfab Quick Fit Industrial Duct

Complete range of Nordfab Quick-Fit (QF) durable duct and fittings for building a complete extraction system. Compared to traditional ducting systems, the QF style duct offers installation savings, adapting to existing systems, improved cleaning and future flexibility.

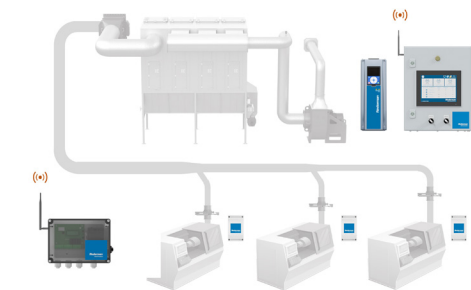

### Nederman SAVE

Nederman SAVE optimizes system performance by monitoring process information and determining the required air and pressure requirements for proper dust extraction and safe material transport. SAVE offers up to a 70% reduction in energy consumption, reduces combustible dust risks and improves system performance.

## myAir Service Offering

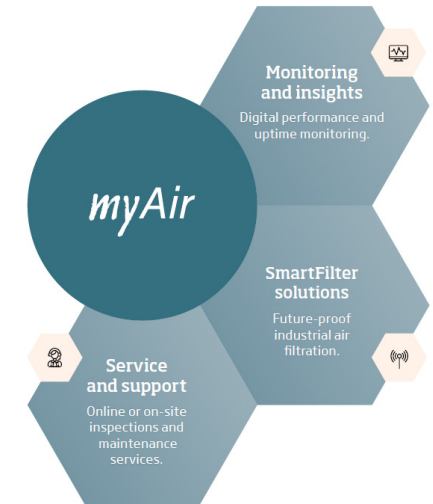

Ensuring and maintaining proper operation for wood dust collection systems is essential for protecting workers from the risk of airborne contaminants and combustible dust. Nederman offers a personalized service platform called myAir.

The platform includes a range of services including traditional on-site inspection and maintenance services. With this comprehensive platform customers can proactively address filter-related issues and improve their overall operational efficiency.

## The Clean Air Company

Nederman offers a comprehensive approach to clean air solutions for the woodworking industry. We consider ourselves a partner in our customers operation and are committed to helping them achieve a productive, profitable and sustainable future. Therefore, we provide complete, turn-key solutions beginning with the system design and continuing through the operation and service resulting in an effective, safe and efficient dust collection system.

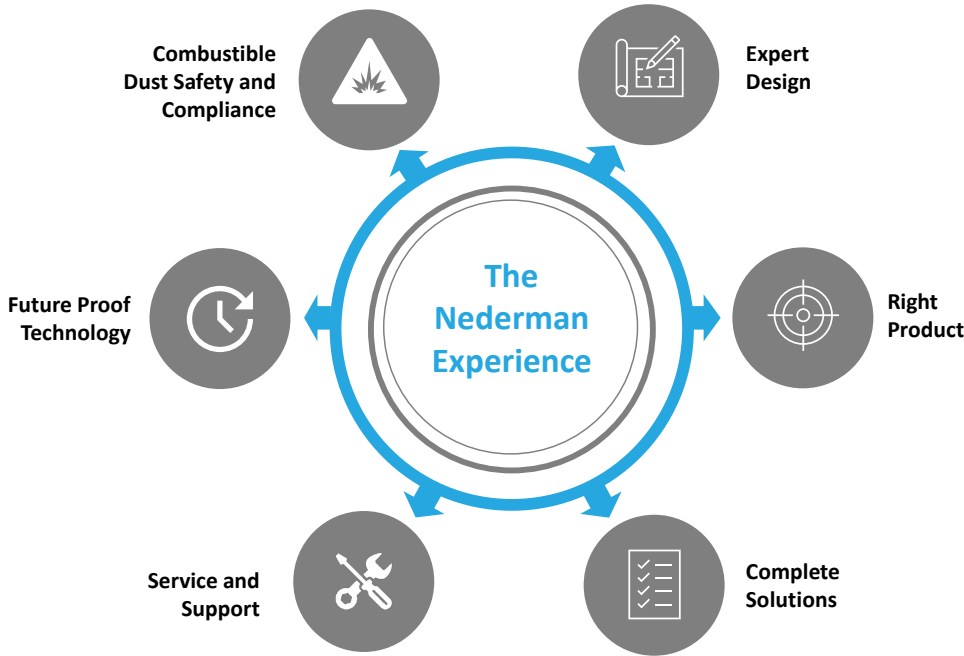





**Nederman**

## The Clean Air Company

Nederman is an environmental technology company and a global leader in industrial air filtration dedicated to extracting, transporting and cleaning air to make industrial production more efficient, safe and sustainable. Based on industry leading products, solutions and services in combination with innovative IoT technology, we monitor and optimize performance and validate emissions compliance to protect people, planet and production.

Nederman | NFPZ | 06-25

Nederman Corporation • 800 522 5286 • [www.nederman.com](http://www.nederman.com)